



Joan Wong

**Office of the Councillor
Elmdale Ward**

111 Sussex Drive
Ottawa, Ontario K1N 5A1
(613) 564-1323
Fax 564-8412

**Bureau de la Conseillère
quartier Elmdale**

111, promenade Sussex
Ottawa (Ontario) K1N 5A1
(613) 564-1323
Télécopieur 564-8412

**FACT SHEET
RUSKIN STREET PARKING LOT**

Last Wednesday, December 2, 1992 the Council adopted a motion to develop 45 Ruskin Street into parkland. This decision concludes 20 years of discussions between the City and the Ottawa Civic Hospital, and marks a new beginning for the City of Ottawa where compromise will dictate discussions on the need for parking and the legitimate concerns for improved parkland and green space.

In 1976, the City notified the Civic Hospital that it was going to develop this property into a park, as it previously was from 1936 to 1959. Throughout the 1980's, the City continued to notify the Civic Hospital that it was going to proceed with this plan. In the summer of 1991, prior to my election as councillor, the City of Ottawa adopted its Official Plan in which it confirmed that 45 Ruskin Street would revert to parkland by 1996. Again, the Civic Hospital was notified of the decision and urged to start planning for the change.

When I was elected in the Fall of 1991, after careful analysis I decided that I would pursue my predecessor's intent as stated in the Official Plan of the City, and work toward the objective of turning this city-owned property into parkland. I was also determined that this would not be done to the detriment of patients and visitors of the Civic Hospital.

At the present time, more than 50% of parking spaces at the Civic Hospital are occupied by day-time staff. Moreover, the city-owned property on Ruskin Street generates approximately \$500,000 a year in revenues. In light of this information, I decided to work with the staff and officials of the Civic Hospital to find a compromise which would simultaneously address the concerns of the City and the neighbourhood community and the need for maintaining parking spaces near the entrance of the Heart Institute and the Cancer Clinic.

The City, the Civic Hospital and my office reached this compromise in May of 1992, in an unprecedented show of consensus and cooperation. For your information, enclosed you will find a map detailing the compromise to:

1. move the parking lot closer to the entrance of the Heart Institute and the Cancer Clinic;
2. maintain the same number of parking spaces at the Civic Hospital;
3. at the request of the Hospital, the Civic Hospital would redevelop the parking layout as shown on the enclosed map, within 12 months, including an understanding with the hospital that minimal disruptions to parking would be caused during the moving of the parking lot.

...continued on other side



Joan Wong

**Office of the Councillor
Elmdale Ward**

111 Sussex Drive
Ottawa, Ontario K1N 5A1
(613) 564-1323
Fax 564-8412

**Bureau de la Conseillère
quartier Elmdale**

111, promenade Sussex
Ottawa (Ontario) K1N 5A1
(613) 564-1323
Télécopieur 564-8412

4. that all revenues from the new lot (app. \$500,000 a year) would continue to be used for health care by the Civic Hospital; and
5. that the City of Ottawa would transfer ownership of the new parking lot, at no cost, to the Corporation of the Ottawa Civic Hospital.
6. allow for the future development of additional parking at the Civic Hospital by constructing an underground structure which would allow more space for patients and their visitors; this project would generate significant net profits for the Civic Hospital.

As someone stated, leadership is bringing people to work together towards achieving a compromise which addresses the concerns of all parties involved. This is what we achieved in this compromise and this is why the Council of the City of Ottawa overwhelmingly supported the motion to designate this property a park.

I urge everyone concerned with the well-being of the patients and their visitors to support the proposal to move the parking lot closer to the entrance of the Heart Institute and the Cancer Clinic, while maintaining the same number of parking spaces and increasing parkland in our beautiful city.

(Ce document est aussi disponible en français)

Att: Map of the proposed new parking lot on Ruskin Street and indications for new parking spaces to maintain status quo

part of the land
to revert to parkland

Same number of parking
spaces to be provided

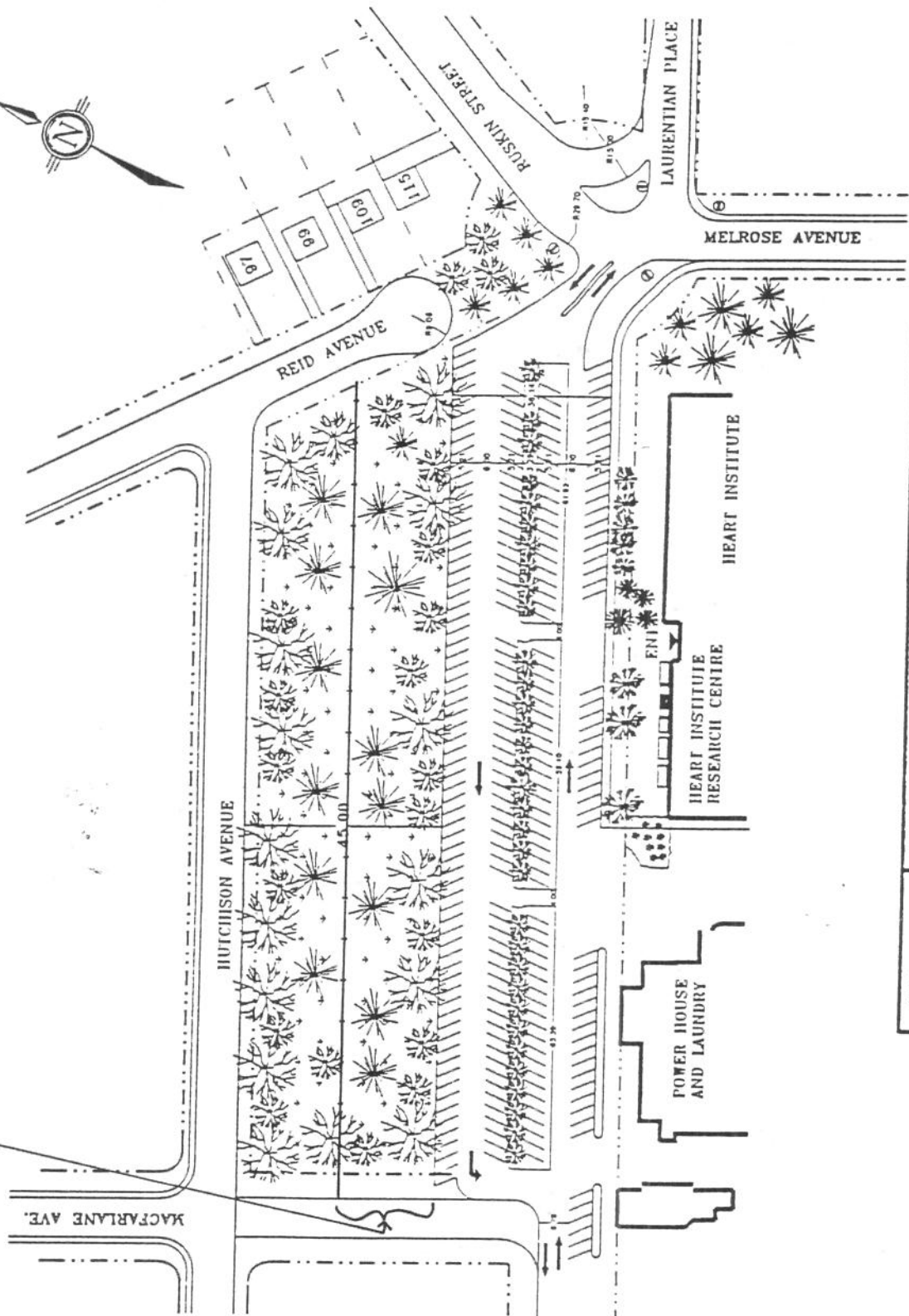
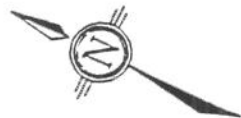

INIT.
M.S.
SCALE
N.T.S.

DEPARTMENT of ENGINEERING and WORKS
TRANSPORTATION and PARKING BRANCH

PROPOSED RUSKIN PARKING LOT

DATE

MAY, 1992

SKETCH No.

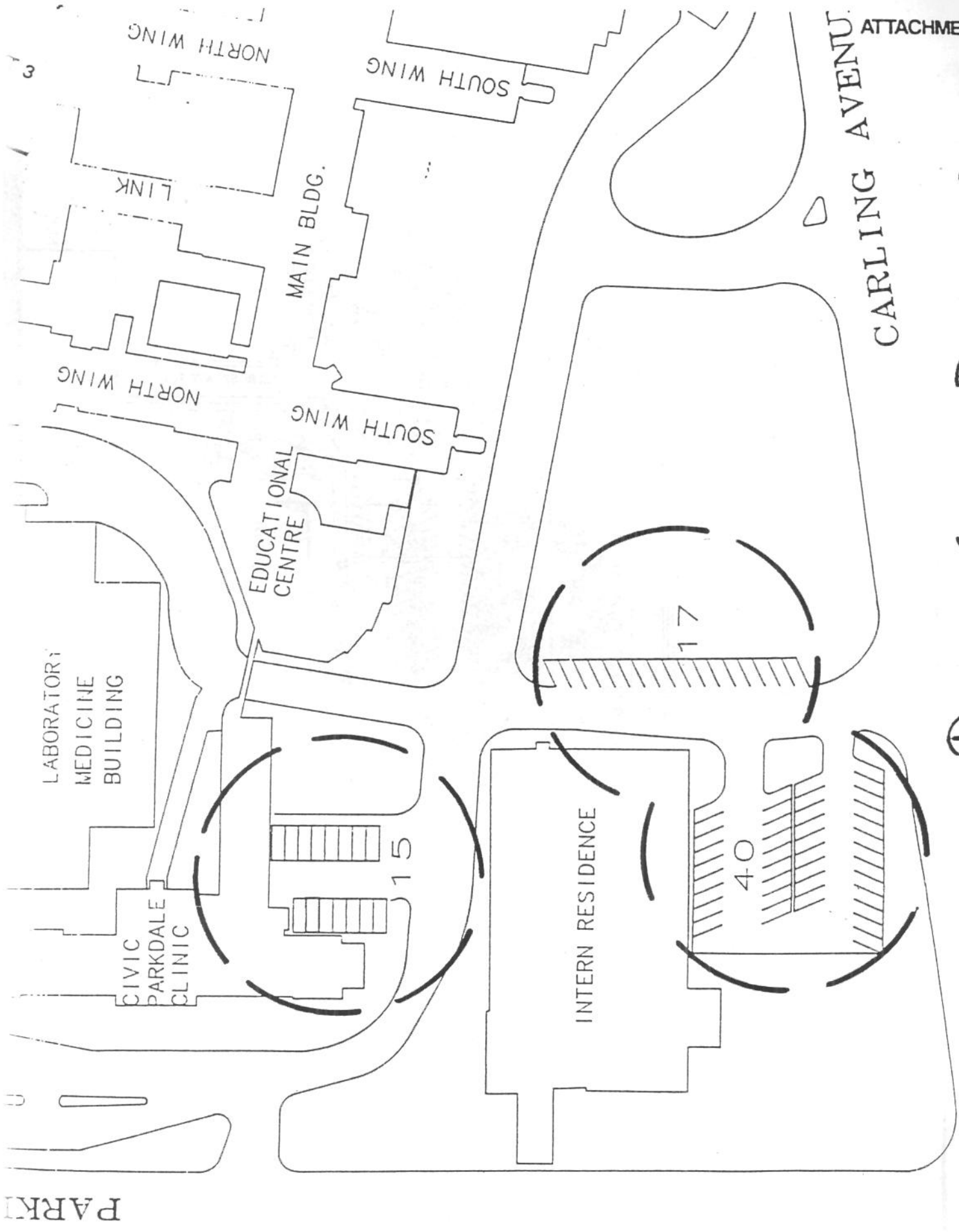

CARLING AVENUE

Proposed Surface Parking - Carling